

**DIRECTIONS:**



**TURN SOUTH OFF OF GORDON DR. ONTO S. FAIRMOUNT**

**TAKE A LEFT ( GO EAST) AT THE FIRST STREET, AFTER TURNING OFF OF GORDON DR.**

**TURN LEFT INTO THE DRIVEWAY WHICH WILL LEAD DOWN INTO THE PARKING LOT.**

**THE COMPLEX IS LOCATED ACROSS THE STREET FROM GREENVILLE PHARMACY. (BEHIND THE OLD FIRE STATION).**

**COMPLEX PHONE NUMBER:  
(712) 252-3022**

**FOR AN APPLICATION  
PLEASE CONTACT:**



**Connections Area Agency on Aging**

**Toll Free: 800-432-9209**

**Fax: 712-258-0237**

**Website: [www.connectionsaaa.org](http://www.connectionsaaa.org)**

**Email:  
[siouxlandcaaa@connectionsaaa.org](mailto:siouxlandcaaa@connectionsaaa.org)**

**FAIRMOUNT PARK**



**CLOSE TO PHARMACY**

“NEXT TO BUS ROUTE”

**CONGREGATE MEAL SITE  
LOCATION:  
MONDAY THRU FRIDAY**

**210 S. Fairmount  
Sioux City, IA 51106**

**Phone: 712-252-3022**

**CONNECTIONS AREA AGENCY ON AGING**

# Fairmount Park Senior Housing

## REQUIREMENTS:

- **Age 62+**
- **Income:**  
**Single**— \$23,750 gross annual income  
**Couple**—\$27,150 gross annual income

### **WOODBURY COUNTY income limits:**

(If you have funds in the bank, only the interest is counted as income. All income must be verified. This is done during the process of the application.

- Rent varies according to income; medical expenses may affect rent.

## DESCRIPTION OF BUILDING:

- 46 units on 3 levels, 540 sq. feet per unit
- Elevator
- Shower
- Refrigerator / electric stove
- Tub / shower combo or shower
- Unit heat / air conditioning
- Off street parking for tenants
- Pest control service
- Three handicapped accessible units



## LAUNDRY / TRASH:

- Laundry is coin operated, and is located on lower level. Machines take quarters only.
- Trash chutes and/or bins are located at the west end of each hall. All garbage must be bagged and tied.

## UTILITIES:

- Utilities are paid by Fairmount Park except phone/cable. You must arrange for phone/cable yourself.

## GROUND UPKEEP:

- Grounds and walks are cared for at Fairmount Park. (Lawns are mowed and walks are shoveled.)

## PETS:

- The pet deposit is \$300.00. For more details on having a pet at Fairmount Park, a Pet Policy is available.

## FREEZERS:

- Apartment size freezers (5 cubic feet maximum) are allowed. A \$5.00 monthly fee is required for additional utility usage from freezer. You are responsible for any and all damages.

## RENT:

- In order to know how much your rent will be you must fill out an application and the required paperwork. Only then can we tell if you qualify and what your rent amount will be.
- At move-in, resident must pay rent plus one month's rent as a deposit.



**210 S. FAIRMOUNT  
SIOUX CITY, IA 51106**

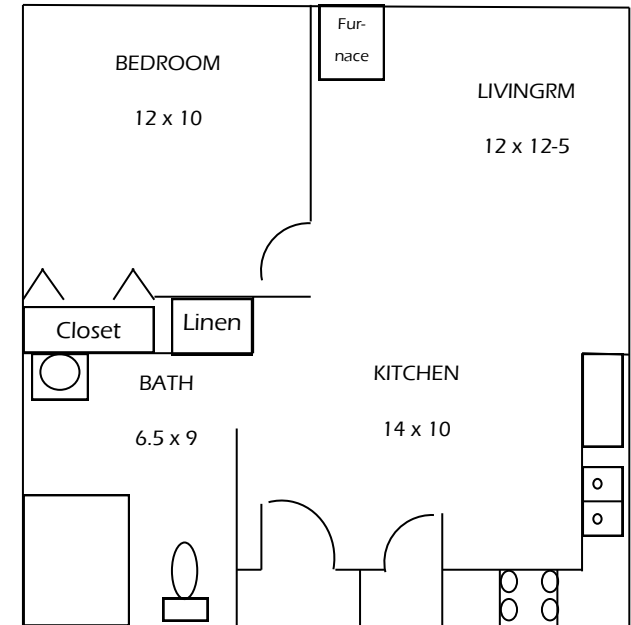

**ALL ONE BEDROOM UNITS**

**MAXIMUM OCC: TWO OCCUPANTS**

**MINIMUM OCC: ONE OCCUPANT**

