

Directions:

Turn South onto 11th Street from Iowa Ave. (By Fiesta Foods)

The complex is located on the West side of 11th Street.

Complex Phone Number:
712-423-9086

FOR AN APPLICATION
PLEASE CONTACT:



Connections Area Agency on Aging

2301 Pierce Street
Sioux City, IA 51104

Phone: 712-279-6900
Toll Free: 800-432-9209
Fax: 712-233-3415

Website: www.connectionsaaa.org
Email:
siouxlandcaaaa@connectionsaaa.org

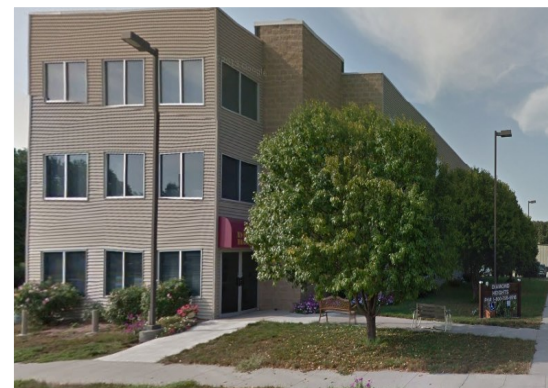

**1018—11TH STREET
ONAWA, IA 51040**

PH: (712) 279-6900

**PLEASE CALL TO
SCHEDULE AN
APARTMENT
VIEWING.**

CONNECTIONS AREA AGENCY ON AGING

Diamond Heights Senior Housing

REQUIREMENTS:

- **Age 62+**
- **Income:**
Single — \$22,200 gross annual income
Couple—\$25,350 gross annual income

MONONA COUNTY income limits:

(If you have funds in the bank, only the interest is counted as income. All income must be verified. This is done during the process of the application.)

- Rent varies according to income; medical expenses may affect rent.

DESCRIPTION OF BUILDING:

- 16 units on 3 levels, 540 sq. feet per unit
- Refrigerator / electric stove
- Tub / shower combination or shower
- Unit heat / air conditioning
- Off street parking for tenants
- Pest control service
- One handicapped accessible unit

LAUNDRY / TRASH:

- Laundry is coin operated, and is located on second floor. Machines take quarters only.

- Trash chutes and/or bins are located at the north end of each hall. All garbage must be bagged and tied.

UTILITIES:

- Utilities are paid by Diamond Heights except phone/cable. You must arrange for phone/cable yourself.

GROUNDS UPKEEP:

- Grounds and walks are cared for at Diamond Heights. (Lawns are mowed and walks are shoveled.)

PETS:

- The pet deposit is \$300.00. For more details on having a pet at Diamond Heights, a Pet Policy is available.

FREEZERS:

- Apartment size freezers (5 cubic feet maximum) are allowed. A \$5.00 monthly fee is required for additional utility usage from freezer. You are responsible for any and all damages.

RENT:

- In order to know how much your rent will be you must fill out an application and the required paperwork. Only then can we tell if you qualify and what your rent amount will be.
- At move-in, resident must pay rent plus one month's rent as a deposit.

ALL ONE BEDROOM UNITS
MAXIMUM OCC: TWO OCCUPANTS
MINIMUM OCC: ONE OCCUPANT

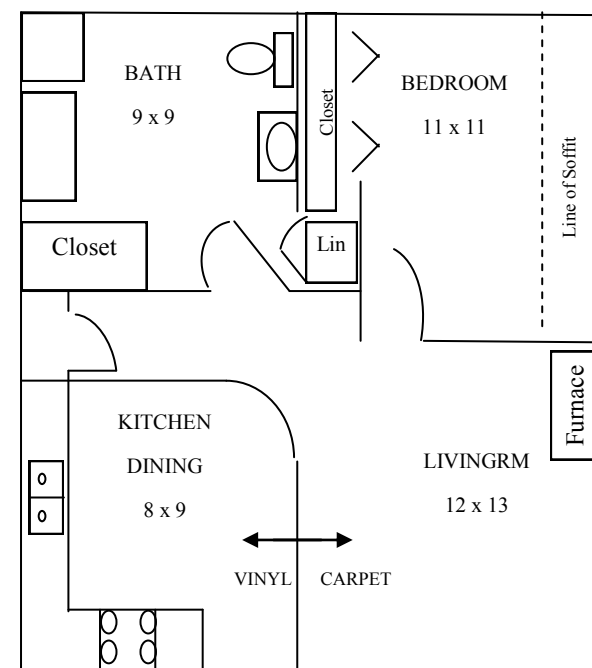

1018 11th Street
Onawa, IA 51040

